

BROKK

60

NEW 2013!



More power in minimal spaces

THE BROKK 60 is the perfect solution for safe and effective demolition in confined spaces. It is the smallest model in the Brokk family – actually the smallest remote-controlled demolition machine in the world – yet at least 7-8 times as effective as handheld equipment. And the Brokk 60 does not get tired. This combination of power, size and light weight works wonders in places where it previously was impossible to carry out mechanized demolition work. Compared to its' older brother – Brokk 50 – the Brokk 60 boosts productivity with 25 percent

with a stronger breaker, faster movements, a new control system and an (even) lower profile. The low weight makes it ideal for indoor work on weak floors and it can be transported in an ordinary passenger elevator. It can even "walk" up and down staircases. On top of everything else, the Brokk 60 has a more durable design with protective steel plates, larger-dimensioned components and more industrial service features.

One size bigger in everything. Except for the size.

APPLICATIONS

Demolition work in confined spaces and small-scale maintenance and refurbishing work.

RANGE

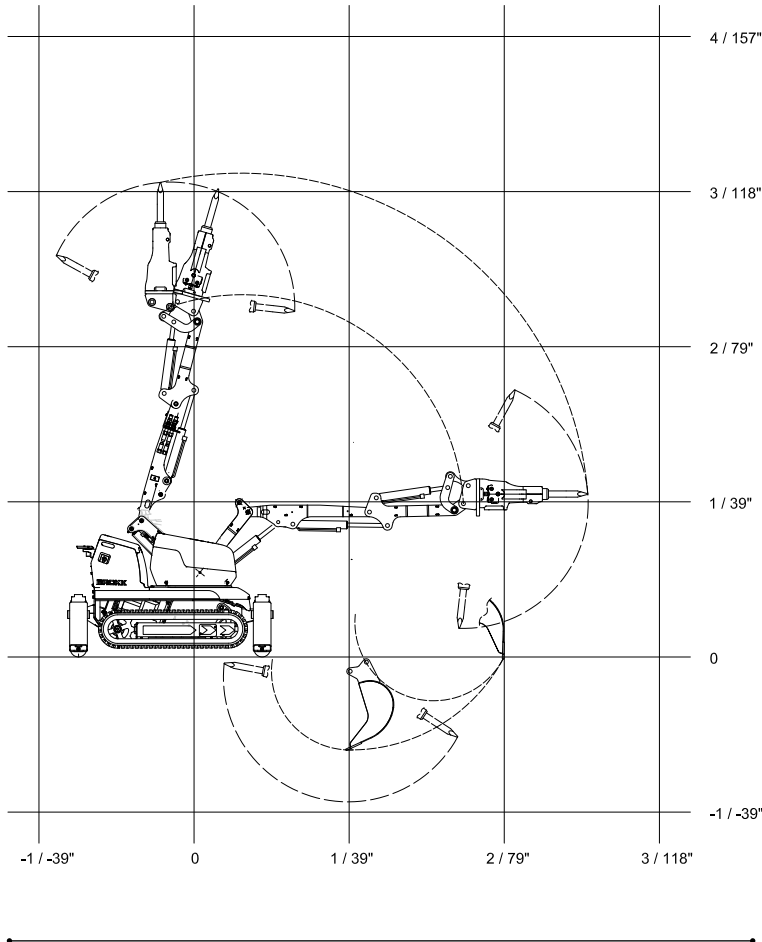

m / in

SIZE

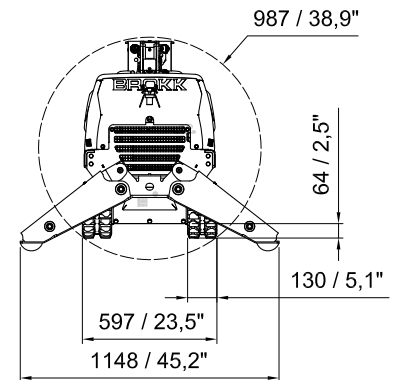
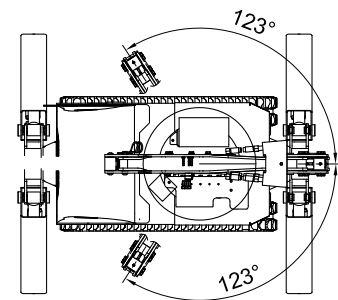
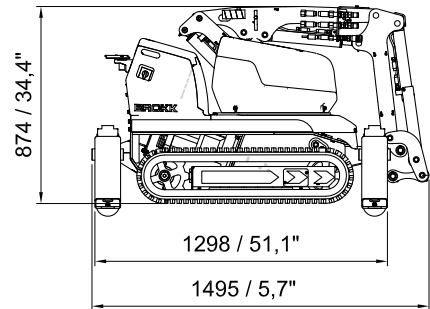
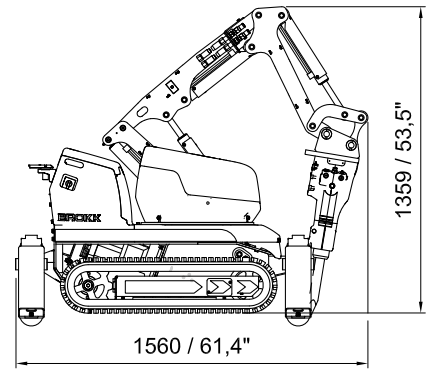

TECHNICAL DATA

Hydraulic breaker in illustrations
Load and stability diagram can be ordered from Brokk AB

SB 52

Performance

Slewing speed 6.5 sec/245°
Transport speed, max. 2.5 km/h; 0.7 m/s; 1.6 mph
Incline angle, max. 30°

Hydraulic system

Hydraulic system capacity 27 l; 7.1 US gal
Pump type Gear pump with fixed displacement
System pressure 18 MPa; 2,610 psi
Pump flow max 50Hz and 60Hz 22 l/min; 5.8 US gal/min

Electric motor

Type ABB
Output* 5.5 kW
Current* 14 A
Starting device Direct start

Control system

Control type Portable control box
Signal code Digital
Transfer Cable/Radio

Weight

Weight of basic machine excluding attachment 500 kg; 1,102 lb

Noise level

Sound power level Lwa, measured according to directive 2000/14/EC 82.9 dB(A)

TOOLS



* Valid for 400V/50Hz